

SERIES S 400 | SINGLE STAGE HP REGULATOR

- Piston single stage
- Purity up to 6.0
- Inlet pressure:
300 bar (4350 psi)
- Outlet pressure:
200 bar (2900 psi)

- ★ 1 inlet / 1 outlet
- ★ Rear thread for panel mounting
- ★ O₂ application compatible with brass version only
- ★ Inlet/outlet pressure gauges

Special requirements on request

APPLICATIONS

- Designed for cylinder regulator applications.
- Ideally suited to put vessels under pressure, leak detection and purge of pipe work.

KEY FEATURES

- Similar to the series S250 but with a higher possible outlet pressure (200 bar)
- Decompression of the downstream regulation system possible by turning the hand wheel counter-clockwise (SL 400).
- Accurate pressure control for reliable service.
- The SLS 400 version has a connection available so that a relief valve can be installed.
- Panel mounting possible due the rear threads.
- Can also be equipped with a shut off valve at the outlet.

To be connected with cylinder connectors



Refer to page 90

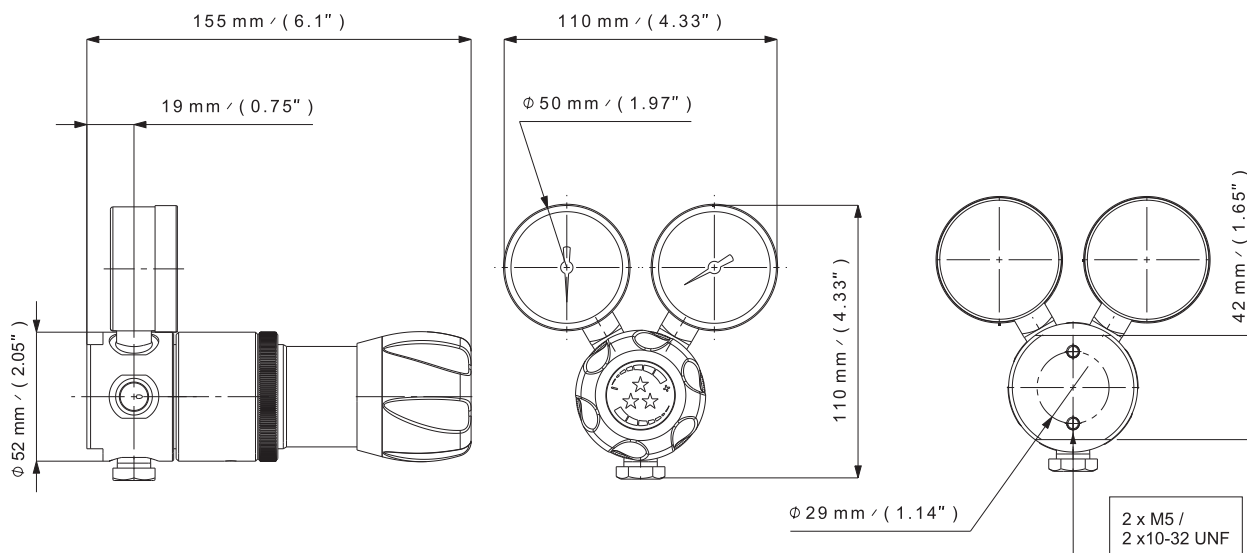

SPECIFICATIONS

Female ports	16 x 1.336 (inlet) - G 3/8 (outlet) or 1/4 NPT (inlet/outlet)	Weight	± 1,6 kg ± 3.5 lbs	Inlet pressure	300 bar 4350 psi
Seat seal	PCTFE	Leak rate	10 ⁻⁸ mbar ℓ/s He	Outlet pressure	200 bar 2900 psi
O-ring	NBR EPDM - Standard FPM	Temperature range	- 20°C to + 60°C - 4°F to + 140°F	Nominal Flow	30 Nm³/h (N₂)
Piston	AISI 316L	Gauges	High and low pressure (M10 x 1 or 1/4 NPT)	Oxygen use	Brass only

FLOW CURVES

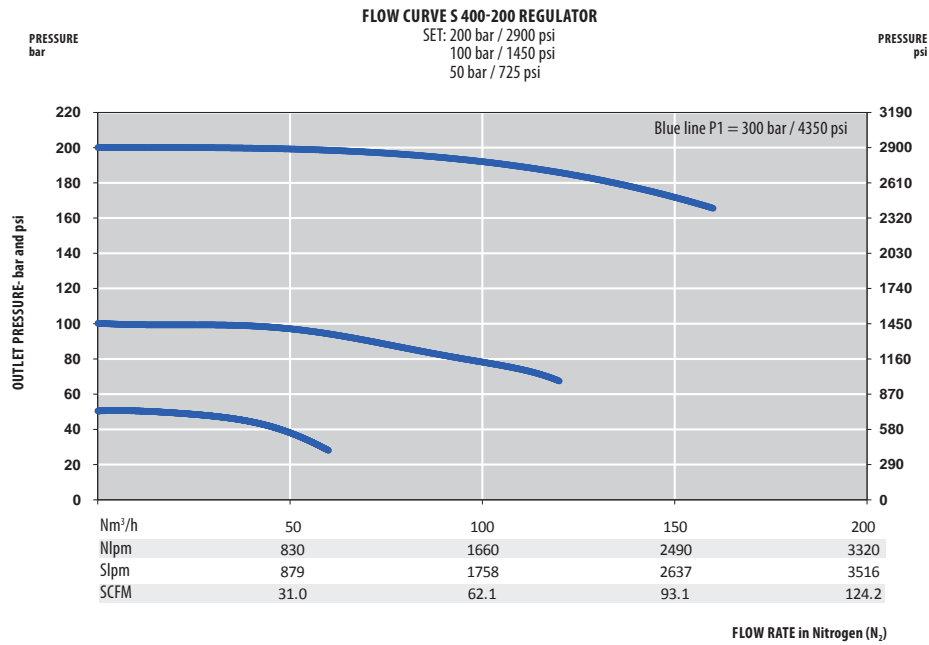

PRODUCT CONFIGURATOR

	Body Material		Safety Relief Valve Configuration		End Connections		O-ring Material	Gauges	
S	L		-		400	N		1	
	Chrome plated brass	L	With decompression system	-	16 x 1.336 - G 3/8	16	NBR	With	1
	Stainless steel	I	With a safety valve connection available	S	1/4 NPT - 1/4 NPT	N	EPDM - Standard		
							FPM		